

Torsional Highflex Couplings

RINGFEDER® TNR 2425.1

Single-row, SAE flange-shaft connections with taper clamping bush

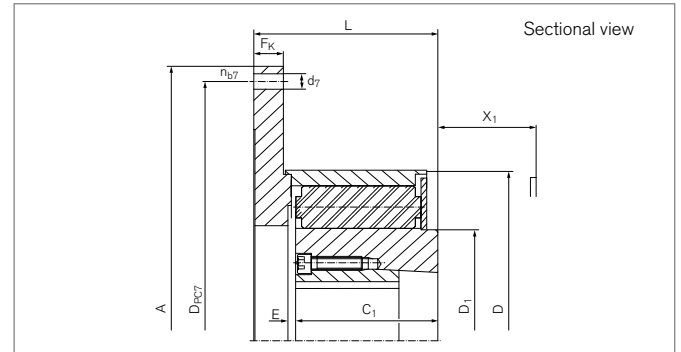

| Size | Taper bushing | SAE size | A | D _{PC7} | d ₇ | n _{b7} | D | D ₁ | C ₁ |
|--------------|---------------|----------|-------|------------------|----------------|-----------------|-----|----------------|----------------|
| | | | mm | mm | mm | | mm | mm | mm |
| 120.1 - 06.5 | 1615 | 6,5 | 215,9 | 200,0 | 9,5 | 6 | 120 | 73 | 52,0 |
| 120.1 - 07.5 | 1615 | 7,5 | 241,3 | 222,3 | 9,5 | 8 | 120 | 73 | 52,0 |
| 120.1 - 08.0 | 1615 | 8,0 | 263,5 | 244,5 | 11,0 | 6 | 120 | 73 | 52,0 |
| 120.1 - 10.0 | 1615 | 10,0 | 314,3 | 295,3 | 11,0 | 8 | 120 | 73 | 52,0 |
| 160.1 - 06.5 | 2012 | 6,5 | 215,9 | 200,0 | 9,5 | 6 | 160 | 100 | 64,0 |
| 160.1 - 07.5 | 2012 | 7,5 | 241,3 | 222,3 | 9,5 | 8 | 160 | 100 | 64,0 |
| 160.1 - 08.0 | 2012 | 8,0 | 263,5 | 244,5 | 11,0 | 6 | 160 | 100 | 64,0 |
| 160.1 - 10.0 | 2012 | 10,0 | 314,3 | 295,3 | 11,0 | 8 | 160 | 100 | 64,0 |
| 200.1 - 07.5 | 2517 | 7,5 | 222,3 | 213,3 | 9,5 | 8 | 200 | 129 | 80,0 |
| 200.1 - 08.0 | 2517 | 8,0 | 263,5 | 244,5 | 11,0 | 6 | 200 | 129 | 80,0 |
| 200.1 - 10.0 | 2517 | 10,0 | 314,3 | 295,3 | 11,0 | 8 | 200 | 129 | 80,0 |
| 200.1 - 11.5 | 2517 | 11,5 | 352,4 | 333,7 | 11,0 | 8 | 200 | 129 | 80,0 |
| 260.1 - 10.0 | 3535 | 10,0 | 314,3 | 295,3 | 11,0 | 8 | 260 | 165 | 100,0 |
| 260.1 - 11.5 | 3535 | 11,5 | 352,4 | 333,7 | 11,0 | 8 | 260 | 165 | 100,0 |
| 260.1 - 14.0 | 3535 | 14,0 | 466,7 | 438,2 | 14,5 | 8 | 260 | 165 | 100,0 |
| 260.1 - 16.0 | 3535 | 16,0 | 517,5 | 489,0 | 14,5 | 8 | 260 | 165 | 100,0 |
| 320.1 - 14.0 | 4040 | 14,0 | 466,7 | 438,2 | 14,5 | 8 | 320 | 208 | 125,0 |
| 320.1 - 16.0 | 4040 | 16,0 | 517,5 | 489,0 | 14,5 | 8 | 320 | 208 | 125,0 |
| 320.1 - 18.0 | 4040 | 18,0 | 571,5 | 542,9 | 18,0 | 6 | 320 | 208 | 125,0 |
| 400.1 - 16.0 | 5050 | 16,0 | 517,5 | 489,0 | 14,5 | 8 | 400 | 268 | 156,0 |
| 400.1 - 18.0 | 5050 | 18,0 | 571,5 | 542,9 | 18,0 | 6 | 400 | 268 | 156,0 |
| 400.1 - 21.0 | 5050 | 21,0 | 673,1 | 641,4 | 18,0 | 12 | 400 | 268 | 156,0 |
| 400.1 - 24.0 | 5050 | 24,0 | 733,4 | 692,2 | 22,0 | 12 | 400 | 268 | 156,0 |

Taper bushing bore see chapter „Ordering example“ in Product Paper & Tech Paper „RINGFEDER® Torsional Highflex Couplings“

To continue see next page

Torsional Highflex Couplings RINGFEDER® TNR 2425.1

| Size | L | E | F _E | F _K | X ₁ | J _F | J _N ¹⁾ | G _{wub} ¹⁾ |
|--------------|-----|-----|----------------|----------------|----------------|-----------------------------------|-----------------------------------|--------------------------------|
| | mm | mm | mm | mm | mm | 10 ⁻³ kgm ² | 10 ⁻³ kgm ² | kg |
| 120.1 - 06.5 | 71 | 4,0 | +/- 1,0 | 13 | 41 | 6 | 1,4 | 2,8 |
| 120.1 - 07.5 | 71 | 4,0 | +/- 1,0 | 13 | 41 | 9 | 1,4 | 3,1 |
| 120.1 - 08.0 | 71 | 4,0 | +/- 1,0 | 13 | 41 | 12 | 1,4 | 3,4 |
| 120.1 - 10.0 | 71 | 4,0 | +/- 1,0 | 13 | 41 | 26 | 1,4 | 4,1 |
| 160.1 - 06.5 | 84 | 4,0 | +/- 1,0 | 15 | 50 | 9 | 7,6 | 5,3 |
| 160.1 - 07.5 | 84 | 4,0 | +/- 1,0 | 15 | 50 | 12 | 7,6 | 5,6 |
| 160.1 - 08.0 | 84 | 4,0 | +/- 1,0 | 15 | 50 | 16 | 7,6 | 5,9 |
| 160.1 - 10.0 | 84 | 4,0 | +/- 1,0 | 15 | 50 | 31 | 7,6 | 6,8 |
| 200.1 - 07.5 | 104 | 5,0 | +/- 1,5 | 18 | 64 | 23 | 24 | 10,2 |
| 200.1 - 08.0 | 104 | 5,0 | +/- 1,5 | 18 | 64 | 28 | 24 | 10,6 |
| 200.1 - 10.0 | 104 | 5,0 | +/- 1,5 | 18 | 64 | 45 | 24 | 11,6 |
| 200.1 - 11.5 | 104 | 5,0 | +/- 1,5 | 18 | 64 | 66 | 24 | 12,6 |
| 260.1 - 10.0 | 132 | 6,0 | +/- 1,5 | 24 | 80 | 92 | 80 | 20,3 |
| 260.1 - 11.5 | 132 | 6,0 | +/- 1,5 | 24 | 80 | 118 | 80 | 21,5 |
| 260.1 - 14.0 | 132 | 6,0 | +/- 1,5 | 24 | 80 | 260 | 80 | 25,6 |
| 260.1 - 16.0 | 132 | 6,0 | +/- 1,5 | 24 | 80 | 381 | 80 | 28,0 |
| 320.1 - 14.0 | 162 | 7,0 | +/- 2,0 | 26 | 100 | 474 | 275 | 44,6 |
| 320.1 - 16.0 | 162 | 7,0 | +/- 2,0 | 26 | 100 | 662 | 275 | 47,2 |
| 320.1 - 18.0 | 162 | 7,0 | +/- 2,0 | 26 | 100 | 1195 | 275 | 50,3 |
| 400.1 - 16.0 | 197 | 8,0 | +/- 2,0 | 31 | 126 | 760 | 897 | 83,9 |
| 400.1 - 18.0 | 197 | 8,0 | +/- 2,0 | 31 | 126 | 971 | 897 | 87,6 |
| 400.1 - 21.0 | 197 | 8,0 | +/- 2,0 | 31 | 126 | 1579 | 897 | 95,2 |
| 400.1 - 24.0 | 197 | 8,0 | +/- 2,0 | 31 | 126 | 2035 | 897 | 99,7 |

¹⁾ Weight and mass moment of inertia for hubs without taper lock bushing

Explanations

| | | |
|---|---|---|
| SAE = Flange connection to SAE J 620 d | D₁ = Outer diameter | X₁ = Required space for dismounting of the elastic buffer |
| A = Max. outer diameter | C₁ = Guided length in hub bore | J_F = Moment of inertia on thrust flange side |
| D_{PC7} = Pitch circle diameter of bore holes d ₇ | L = Total length | J_N = Moment of inertia hub side |
| d₇ = Bore diameter | E = Gap width between left and right component | G_{wub} = Weight, unbored |
| n_{b7} = Quantity of bore d ₇ | F_E = Tolerance of the gap width E | |
| D = Outer diameter | F_K = Flange thickness | |

Ordering example

| Series | Size | Buffer | Taper bushing | Bore taper bushing |
|------------|--------------|--------|---------------|--------------------|
| TNR 2425.1 | 200.1 - 08.0 | Pb 70 | 2517 | 28 |

Further information on
RINGFEDER® TNR 2425.1
 on www.ringfeder.com

Disclaimer of liability

All technical details and notes are non-binding and cannot be used as a basis for legal claims. The user is obligated to determine whether the represented products meet his requirements. We reserve the right carry out modifications at any time in the interests of technical progress.